

Summit® ...responsible solutions.®

Year-Round® Spray Oil

FOR ORGANIC GARDENING

For Residential Use Sites Only.
Not for Use in Commercial Agricultural Sites.

KILLS Garden Insects
and Controls Diseases



Use up to the Day of Harvest

KILLS: Whitefly, Aphids, Spider Mites, Mealybug, Scale, Mites, Thrips, Fungus Gnats, & other insects as listed. CONTROLS: Sooty Mold, Powdery Mildew, and other diseases as listed. USE ON: Fruits & Vegetables, Flowers, Ornamentals, Trees & Shrubs as listed in the booklet labeling.

ACTIVE INGREDIENT Mineral Oil98.8%
OTHER INGREDIENTS 1.2%
Contains petroleum distillate
7.05 lbs. of ingredients per gallon

EPA Reg No. 6218-71 EPA Est. No. 6218-MS-2

FOR RESIDENTIAL AND HOME GARDEN USE ONLY.
Not for use on agricultural establishments covered by the WPS (40 CFR Part 170)

KEEP OUT OF REACH OF CHILDREN
CAUTION

Summit®
...responsible solutions.
235 South Kresson Street, Baltimore, MD 21224
800-227-8664 | 410-522-0661
®Registered Trademark of Summit Chemical Co.

HAZARD TO HUMANS AND DOMESTIC ANIMALS: Avoid contact with eyes, skin and clothing. Additional precautionary statements are contained in this booklet. Harmful if swallowed. Avoid breathing of spray mists or vapors. Wash hands after use. Avoid contamination of feed or foodstuffs. Wear long sleeved shirt, long pants, shoes and socks.

ATTENTION: This specimen label is provided for informational use only. This product may not yet be available for sale in your state or area. The information found in this label may differ from the information found on the product label you are using. Always follow the instructions for use and precautions on the label of the product you are using

**Year-Round®
Spray Oil**

| PRODUCT FACTS | |
|----------------------------------|--|
| What It Is: | Horticultural spray oil that suffocates insects and fungus rather than use toxins. |
| What It Does: | KILLS Whitefly, Aphids, Spider Mites, Mealybug, Scale, Mites, Thrips, Fungus Gnats, & other insects as listed. CONTROLS: Sooty Mold, Powdery Mildew, and other diseases as listed. |
| Where To Use: | Fruits & Vegetables, Flowers, Ornamentals, Trees & Shrubs as listed in the booklet labeling. |
| Coverage | Makes up to 25 gallons of End Use Material. |
| Questions & Comments: | Call 1-800-227-8664 or visit our website at www.SummitResponsibleSolutions.com |

| FIRST AID | |
|---|---|
| <p>If Inhaled:</p> <ul style="list-style-type: none"> • Move person to fresh air. • If person is not breathing, call 911 or an ambulance, then give artificial respiration, preferably by mouth to mouth, if possible. • Call a poison control center or doctor for further treatment advice. <p>If in eyes:</p> <ul style="list-style-type: none"> • Hold eye open and rinse slowly and gently with water for 15-20 minutes. • Remove contact lenses, if present, after the first 5 minutes, then continue rinsing eye. • Call poison control center or doctor for treatment advice. | <p>If on skin or clothing:</p> <ul style="list-style-type: none"> • Take off contaminated clothing. • Rinse skin immediately with plenty of water for 15-20 minutes. • Call a poison control center or doctor for treatment advice. <p>If swallowed:</p> <ul style="list-style-type: none"> • Immediately call a poison control center or doctor • Do not induce vomiting unless told to do so by the poison control center or doctor. • Do not give any liquid to the person. • Do not give anything by mouth to an unconscious person. |

HOT LINE NUMBER
Have the product container or label with you when calling a poison control center or doctor or going for treatment. For non-emergency information on product use, etc., call the National Pesticides Information Center (NPIC) at 1-800-858-7378 (NPIC Web site: www.npic.orst.edu). For emergencies, call the poison control center 1-800-222-1222.

NOTE TO PHYSICIAN
Contains petroleum distillate. Vomiting may cause aspiration pneumonia.

Summit® ...responsible solutions.®

ENVIRONMENTAL HAZARDS

This product is toxic to fish. To protect the environment, do not allow pesticide to enter or run off into storm drains, drainage ditches, gutters, or surface waters. Applying this product in calm weather when rain is not predicted for the next 24 hours will help to ensure that wind or rain does not blow or wash pesticide off the treatment area. Rinsing application equipment over the treated area will help avoid run off to water bodies or drainage systems.

PHYSICAL OR CHEMICAL HAZARDS

Avoid contact with powerful oxidants such as liquid chlorine, concentrated oxygen, sodium hypochlorite and calcium hypochlorite.

STORAGE AND DISPOSAL

Do not contaminate water, food, or feed by storage or disposal.

PESTICIDE STORAGE: Store in a cool, dry place. Do not store near heat or open flame.

PESTICIDE DISPOSAL: Waste resulting from the use of this product must be disposed of on site or at an approved waste disposal facility.

Non-refillable container. Do not reuse or refill this container. Offer for recycling if available.

IF EMPTY: Non-refillable container. Do not reuse this container. Place in trash or offer for recycling if available.

IF PARTLY FILLED: Call your local solid waste agency or call 1-800-CLEANUP for disposal instructions. Never place unused product down any indoor or outdoor drain.

DIRECTIONS FOR USE

It is a violation of Federal law to use this product in a manner inconsistent with its labeling. Do not apply this product through any type of irrigation system. Do not enter or allow others to enter treated areas until sprays have dried.

USE PRECAUTIONS

Do not spray plants suffering from drought (moisture stress). Do not apply during periods of prolonged high temperature combined with high relative humidity. Do not use this insecticide with dimetholate, herbicides or fungicides such as Captan, Folpet, Dyrene, Karathene, Morestan or any product containing sulfur. Do not use with Sevin 50w formulation (carbaryl) on deciduous fruit trees. Keep spray equipment used for these other products separate from the equipment used for this insecticide or make sure the sprayer is thoroughly cleaned so that no residue from these other products remain. Do not apply this product in a way that will contact any person or pet, either directly or through drift. Keep people and pets out of the area during application. Do not allow people or pets to enter the treated area until sprays have dried.

MIXING DIRECTIONS

Make sure the spray equipment to be used is clean dry and odor free. The attached sprayer is calibrated to deliver a 1 to 100 dilution.

Hose-end convenience!

Automatically mixes with water! No measuring or separate applicator!

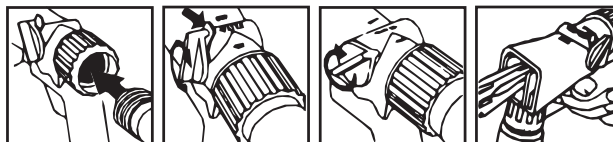

1. Attach garden hose to spray nozzle and turn on water supply.
2. Bend safety tab down and turn control to "Water". Clear water will spray.
3. Point nozzle toward item to be sprayed and turn water control knob to "On" to automatically mix with water.
4. Hold bottle level. Use with average water pressure. When finished spraying turn knob to off/closed position.

APPLICATION INSTRUCTIONS

- The best times to spray are early evening and early morning.
- Completely cover the target pest and plant with spray solution.
- Do not exceed the maximum rates or apply more than specified.
- Certain plants may be sensitive to oil. A small number of plants should be test sprayed prior to general spraying.
- Use caution on open blooms — bleaching and spotting have been observed on the open bloom of certain plants.
- May be used up to day of harvest.

Summit® ...responsible solutions.®

TABLE 1A - FRUIT TREES

| CROP | PEST | TIME OF APPLICATION |
|--------|--|---|
| Apples | Aphids (eggs) / Apple red bug / Mites (eggs) including European red mite / Scales (hard, soft) / Sourly scale / Fruit tree leafroller (eggs) Mites | Dormant or delayed dormant to ½" green. Summer (foliar or cover or postharvest). Do not apply over fruit after waxy bloom forms. |
| Pears | European red mite (eggs) / Pear leaf blister mite (eggs) / Pear psyllid, Scales / Fruit tree leaf roller (eggs) Two-spotted spider mite / Brown mite / Pear rust mite / Pear leaf blister mite / Pear psyllid | Dormant or delayed dormant (up to and including petal fall) Summer (foliar or cover) or postharvest |

TABLE 1B - FRUIT TREES

| CROP | PEST | TIME OF APPLICATION |
|-------------------------------|--|--|
| Almonds / Apricots / Cherries | Aphids (eggs) / Fruit tree leafroller (eggs) / Tent caterpillars / San Jose scale Mites and scales | Dormant or delayed dormant Summer (foliar or cover) or postharvest Application should not be made on oil sensitive varieties. Do not apply to trees lacking adequate moisture |
| Peaches / Nectarine | Aphids (eggs) / Fruit tree leaf roller (eggs) / Mites (eggs) / Peach twig borer (hibernacula) / Cottony peach scale / San Jose scale Mites / Scales (immature) | Dormant or delayed dormant Summer (foliar or cover) or postharvest |
| Plum / Prune | Aphids (eggs) / Scale / Mites (eggs) Mites / Scales | Dormant to delayed dormant to ½ green tip Summer (foliar or cover) or postharvest. Do not apply over certain fresh market fruits after bloom starts to form, as the oil spray will remove the waxy bloom. Application should not be made over oil sensitive varieties |
| Pecans | Aphids (eggs) / Scales / Mites (eggs) Aphids / Mites | Dormant Summer (foliar or cover) or postharvest |

TABLE 1C - CITRUS TREES

| CROP | PEST | TIME OF APPLICATION |
|---|---|---|
| Lemon / Grapefruit | Mites / Scales, including California red scale | For enhanced efficacy and less damage to plants, spray during Fall, early Winter, and Spring months when red scales are more easily controlled and trees are generally less reactive to oil. For all citrus oil sprays, ensure adequate moisture, so that leaves should not wilt before noon. |
| Naval and Valencia Oranges / Other citrus Includes nonbearing varieties | Mites including: Rust mite / Spider mite Scales including: Black scale / California red scale / Whitefly / Blackfly / Sooty mold | Oils applied after October may increase cold damage to trees. Oils applied in August and September may affect solids contents and retard coloring. |

TABLE 2 - SHADE TREES, SHRUBS, ORNAMENTALS, FLOWER & FOLIAGE PLANTS, CONIFERS

| TREE or PLANT | PEST | TIME OF APPLICATION |
|---|---|-------------------------------------|
| Shade trees* (dormant) / Shrubs / Conifers / Deciduous broadleaf evergreens / Woody ornamentals / Ornamental trees* | Aphids / Adelgids / Eriophyid mites / Gall mites / Lace bugs / Leaf beetle larvae / Leafminers / | Winter dormant period, as needed |
| Shrubs including: Conifers / Deciduous broadleaf evergreens | Mealybugs / Psyllids (immature) / Sawfly larvae / Scales (immature) / Spider mites / Whiteflies** | Summer (foliar or cover), as needed |
| Flowering & foliage plants Including: Roses / Other flowering shrubs / Bedding plants | | Winter dormant period, as needed |
| Foliage Ornamentals / Other plants | | Summer (foliar or cover), as needed |

*Oil removes the glaucous (blue) bloom from such evergreens as Colorado Blue Spruce and Koster Spruce. Always use lower dosage or test spray oil sensitive plants such as Cryptomeria, Smoke Tree, Chamaecyparis, Juniper, Japanese Holly, and Spruce. Tendency toward sensitivity: Red Cedar and Douglas Fir. Do not spray walnut foliage.

**Most effective on white fly during immature stages.

Up to 4 applications during the growing season are sufficient to control the claimed pests.

RESTRICTIONS: Use a 2-week interval between applications. Do not spray when buds have fully opened and shoot elongation is occurring. For fall dormant applications, do not exceed a rate 2.5 ounces per gallon and limit uses only to American red oak, Japanese black pine, Dogwood, Weeping cherry, Cornelian cherry. Crabapple, Norway maple, and Purple leaf plum.